

Liquid Filling And Sealing Machine

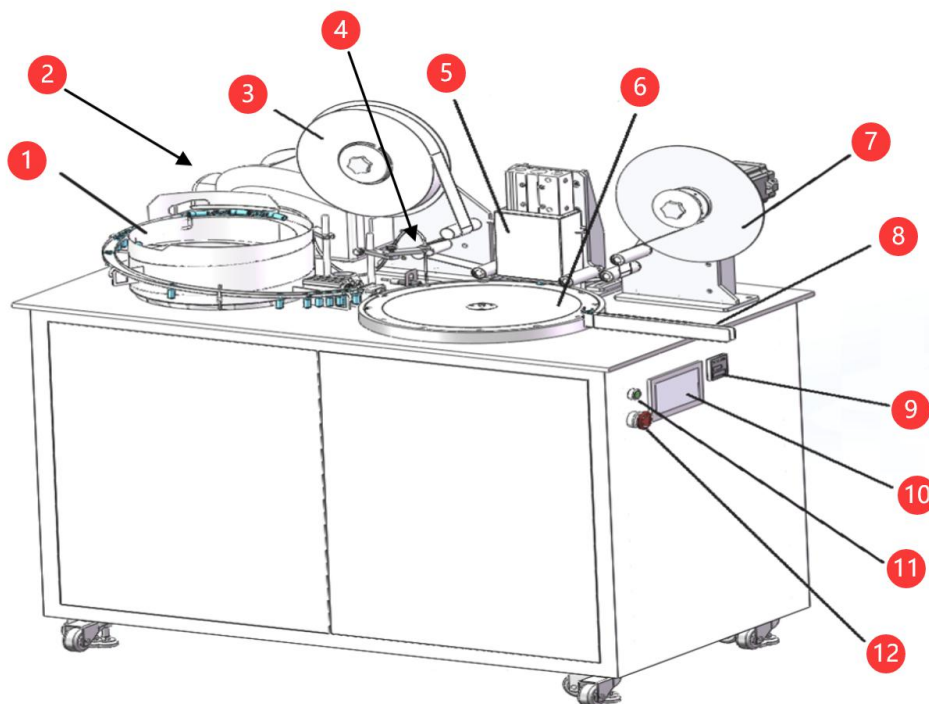

Structure



1	Feeding device	7	Coiling of remaining material
2	Liquid pump	8	Finish product output
3	Foils feeding tray	9	Temperature controller
4	Liquid filling	10	PLC control
5	Cutting and sealing	11	Start
6	Position disk	12	Stop

Parameters:

Working temperature: - 20 °C ~ 60 °C

Power Supply: AC 220V±22V, 50Hz±1Hz

Power: Less than 1000W

Speed: 2,000 - 2,500pcs Per Hour

Filling precision: ±1% (300ul - 2,000ul)

Air consumption: about 10L (ANR)

Pressure: 0.5-0.8MPa

Equipment size: 1,200 mm * 60 mm * 1,400 mm (Double Lid)

Packing size: 1,200 mm * 800 mm * 1,400 mm

Weight: about 210kg

Device properties: custom-built devices

Video:

<https://youtu.be/uzdV9ZVIDQU>